

### PROJECT INFORMATION

CENTER OF TOWER COORDINATES:  
 NAD83:  
 LAT 32° 49' 06.8269"  
 LONG 96° 46' 13.3344"  
 ELEV. 576 (AMSL NAVD88)

NOTES:  
 INGRESS/EGRESS IN COMMON WITH LESSOR.  
 LATITUDE AND LONGITUDE SHOWN HEREON ARE BASED ON NAD83 AND ELEVATIONS NAVD 1988.  
 MAGNETIC DECLINATION INFORMATION TAKEN FROM NOAA WEB SITE AND IS APPROXIMATE.  
 LATITUDE AND LONGITUDE FROM GPS OBSERVATIONS PERFORMED COINCIDENT WITH SURVEY, 1983 NORTH AMERICAN DATUM.  
 BASIS OF ELEVATION: GPS OBSERVATIONS PERFORMED COINCIDENT WITH SURVEY.  
 BASIS OF BEARINGS: GRID BEARINGS BASED ON GPS OBSERVATIONS PERFORMED COINCIDENT WITH SURVEY.  
 CONVERGENCE ANGLE: 0° 56' 36"

BY GRAPHIC PLOTTING ONLY, THIS PROPERTY IS WITHIN ZONE "X", AREAS OUTSIDE OF A 100 YR. FLOOD PLAIN AS SHOWN BY FIRM MAP COMMUNITY PANEL NUMBER 48113C0335K, DATED 07/07/2014. NO SURVEYING WAS DONE TO DETERMINE THIS FLOOD ZONE.

- ### LEGEND
- ⊙ PP - POWER POLE
  - ⊙ TPED - TELEPHONE RISER
  - ⊙ WV - WATER VALVE
  - ⊙ FH - FIRE HYDRANT
  - ⊙ TOWER CENTROID
  - ⊙ LP - LIGHT POLE
  - ⊙ EM - ELECTRIC METER
  - ⊙ GM - GAS METER
  - ⊙ IRS - IRON ROD SET
  - ⊙ IRF - IRON ROD FOUND
  - ⊙ TBM BENCH MARK
  - ▭ BUILDING LINES
  - FENCE LINE
  - GHP - POWER LINE

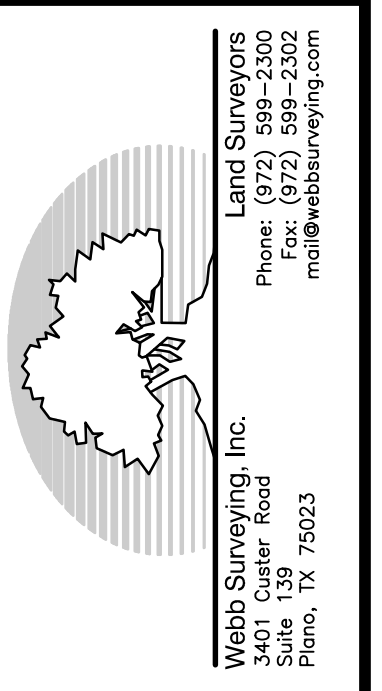
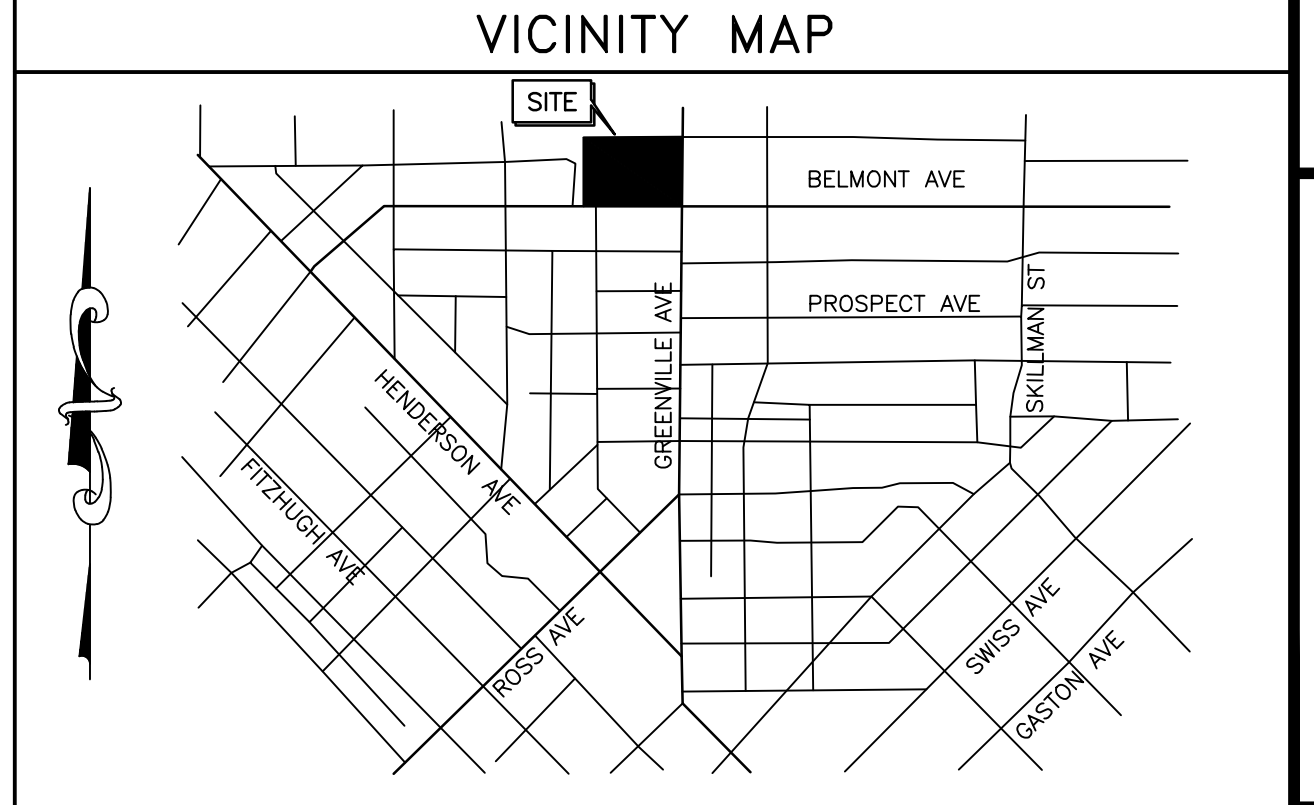

### OVERALL SITE PLAN

SITE NAME: DALLAS VICKERY TOWERS  
 SITE NUMBER: 182834  
 5619 BELMONT AVENUE  
 DALLAS, TX 75205

APPLICANTS:  
 NEW CINGULAR WIRELESS  
 T-MOBILE  
 VERIZON WIRELESS

SITE PLAN SCALE: 1" = 50'  
 NOTE: IF DRAWING IS 11"x17" REFER TO GRAPHIC SCALE.

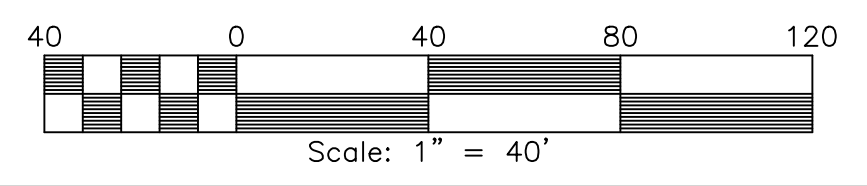
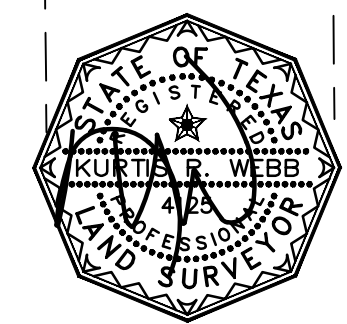

Zoning Case No.:  
 Z145-274